



M12 male connectors

All measures in the drawings are in mm



These standard M12 connectors are ready for the installation on the switches. Their wires have the right length for the connection to the contact blocks and are provided with wire-end sleeves. On request they can be delivered already wired to the switch. The connectors are used where a very short machine down time is required (e.g. in big plants). The connector-provided switch can be replaced very quickly with an identical one with no chance of incorrect wiring.

Technical data:

Max. operating voltage:	250 Vac / 300 Vdc (4 and 5 poles) 30 Vac / 36 Vdc (8 and 12 poles)
Max. operating current:	4 A (4 and 5 poles) 2 A (8 poles) 1.5 A (12 poles)
Protection degree:	IP67 acc. to EN 60529
Ambient temperature:	-25°C ... +80°C
Tightening torque:	1 ... 1.5 Nm
Wire cross-section:	0.5 mm ² (20 AWG) for 4 and 5 poles 0.25 mm ² (23 AWG) for 8 poles 0.14 mm ² (26 AWG) for 12 poles
Contact type:	gold-plated

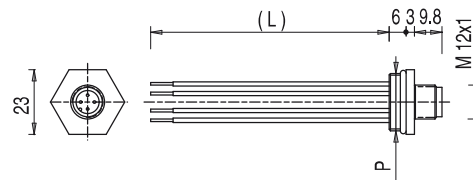

Pin assignment

4 poles		5 poles		8 poles		12 poles	
Pin	Colour	Pin	Colour	Pin	Colour	Pin	Colour
1	Brown	1	Brown	1	White	1	Brown
2	White	2	White	2	Brown	2	Blue
3	Blue	3	Blue	3	Green	3	White
4	Black	4	Black	4	Yellow	4	Green
		5	Grey	5	Grey	5	Pink
				6	Pink	6	Yellow
				7	Blue	7	Black
				8	Red	8	Grey
						9	Red
						10	Purple
						11	Grey-Pink
						12	Red-Blue

Code structure

Attention! The feasibility of a code number does not mean the effective availability of a product. Please contact our sales office.

article		options	
VF CNM5MM-L100			
Body material		Cable length (L)	
M metal		8.5 cm (standard)	
P plastic		L16 16 cm	
		L100 100 cm	
		L200 200 cm	
No. of poles		Connection type	
4 4 poles		M M12x1	
5 5 poles		Connector thread (P)	
8 8 poles		M M20 x 1.5 (standard)	
12 12 poles		P PG 13.5	

Stock items

VF CNP8MM
VF CNP5PM
VF CNP5MM
VF CNM8PM
VF CNM8MM
VF CNP4MM
VF CNM4PM
VF CNP4PM
VF CNM5MM
VF CNM5PM
VF CNM12MM-L16
VF CNM4MM

ATTENTION: always disconnect the power supply before removing the connector. The connector is not suitable for separation of electrical loads.
Note: the 12-pole connector is only available in metal with M20x1.5 thread and 16 cm cables.

Items with code on **green** background are stock items

→ The 2D and 3D files are available at www.pizzato.com

M12 female connectors with cable

All measures in the drawings are in mm



Technical data:

- Polyurethane connector body
- Class 6 copper conductors acc. to IEC 60228 - mobile installation
- Gold-plated contacts (resistance < 5 mΩ)
- Self locking ring nut
- High flexibility cable suitable to be used in drag chains, with PVC sheath conforming to IEC 60332-3 and CEI 20-22II. Polyurethane sheath available on request

Technical data:

Max. operating voltage:	250 Vac / 300 Vdc (4 and 5 poles) 30 Vac / 36 Vdc (8 and 12 poles)
Max. operating current:	4 A (4-5 poles), 2 A (8 poles), 1.5 A (12 poles)
Protection degree:	IP67 acc. to EN 60529 IP69K acc. to ISO 20653 <small>(Protect the cables from direct high-pressure and high-temperature jets)</small>
Ambient temperature:	-25°C ... +80°C - fixed installation -15°C ... +80°C - mobile installation
Wire cross-section:	0.34 mm ² (22 AWG) for 4 poles 0.25 mm ² (23 AWG) for 5 and 8 poles 0.14 mm ² (26 AWG) for 12 poles
Minimum bending radius:	> cable diameter x 15

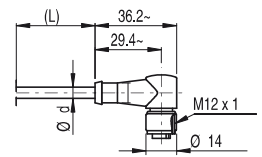
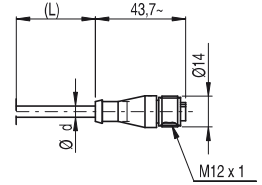

ø d: 5 mm for 4 and 5 poles
6 mm for 8 and 12 poles

Pin assignment

4 poles		5 poles		8 poles		12 poles	
Pin	Colour	Pin	Colour	Pin	Colour	Pin	Colour
1	Brown	1	Brown	1	White	1	Brown
2	White	2	White	2	Brown	2	Blue
3	Blue	3	Blue	3	Green	3	White
4	Black	4	Black	4	Yellow	4	Green
		5	Grey	5	Grey	5	Pink
				6	Pink	6	Yellow
				7	Blue	7	Black
				8	Red	8	Grey
						9	Red
						10	Purple
						11	Grey-Pink
						12	Red-Blue

Code structure

Attention! The feasibility of a code number does not mean the effective availability of a product. Please contact our sales office.

VF CA4PD3M

No. of poles	
4	4 poles
5	5 poles
8	8 poles
12	12 poles

Cable sheath	
P	PVC (standard)
U	PUR

Connector type	
D	straight (standard)
G	angled

Connection type	
M	M12x1

Cable length (L)		No. of poles			
		4	5	8	12
1	1 metre				
2	2 metres				
3	3 metres (standard)	•	•		
4	4 metres				
5	5 metres (standard)	•	•	•	•
...					
0	10 metres (standard)	•	•	•	•

Other lengths on request

Stock items

- VF CA4PD3M
- VF CA4PD5M
- VF CA4PD0M
- VF CA5PD3M
- VF CA5PD5M
- VF CA5PD0M
- VF CA8PD5M
- VF CA8PD0M
- VF CA12PD5M
- VF CA12PD0M

Attention! No stock items, minimum order quantity 100 pcs.

ATTENTION: always disconnect the power supply before removing the connector. The connector is not suitable for separation of electrical loads.

Items with code on green background are stock items

→ The 2D and 3D files are available at www.pizzato.com

M12 extension cable



Technical data:

Polyurethane connector body
 Class 6 copper conductors acc. to IEC 60228
 Gold-plated contacts (resistance < 5 mΩ)
 Self-locking ring nut
 High flexibility cable suitable to be used in drag chains, with PVC sheath conforming to IEC 60332-3 and CEI 20-22II.

Technical data:

Max. operating voltage: 250 Vac / 300 Vdc (5 poles)
 30 Vac / 36 Vdc (8 poles)
 Max. operating current: 4 A (5 poles), 2 A (8 poles)
 Protection degree: IP67 acc. to EN 60529
 Ambient temperature: -25°C ... +80°C - fixed installation
 -15°C ... +80°C - mobile installation
 Wire cross-section: 0.5 mm² (20 AWG) (5 poles)
 0.25 mm² (24 AWG) (8 poles)
 Minimum bending radius: > cable diameter x 15

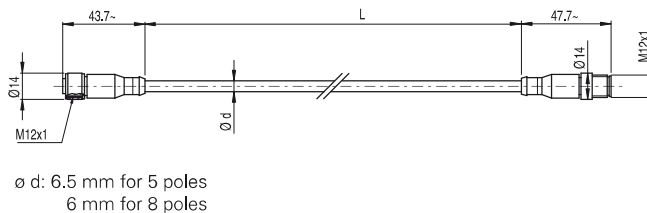

Code structure

VF CA5PD3M-MD

No. of poles		Connection type	
5	5 poles	M	M12x1
8	8 poles		
Cable sheath		No. of poles	
P	PVC	3	5 8
		5	3 metres (standard) • •
		0	5 metres (standard) • •
			10 metres (standard) •
			Other lengths on request
Connector type			
D	straight		

Pin assignment

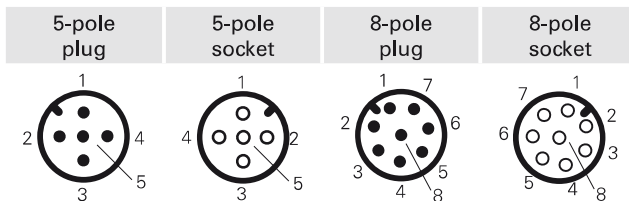

Stock items

- VF CA5PD3M-MD
- VF CA5PD5M-MD
- VF CA5PD0M-MD
- VF CA8PD3M-MD
- VF CA8PD5M-MD

Attention! No stock items, minimum order quantity 100 pcs.

Field wireable M12 female connectors

All measures in the drawings are in mm

General data



Technopolymer connector body
 Gold-plated contacts
 Screw terminals for cable screw fittings
 Max. operating voltages: 250 Vac/dc (4 and 5 poles)
 30 Vac/dc (8 poles)
 Maximum current: 4 A (4 and 5 poles)
 2 A (8 poles)
 Protection degree: IP67 acc. to EN 60529
 Ambient temperature: -25°C ... +85°C
 Wire cross-section: from 0.25 mm² (23 AWG) to 0.5 mm² (20 AWG)

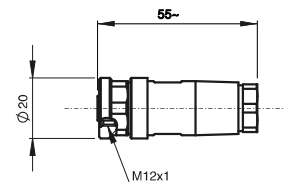

Article	Description	no. of poles
VF CBMP4DM04	Field wireable M12 female connector, straight, for Ø 4 ... Ø 6.5 mm multipolar cables	4
VF CBMP5DM04	Field wireable M12 female connector, straight, for Ø 4 ... Ø 6.5 mm multipolar cables	5
VF CBMP8DM04	Field wireable M12 female connector, straight, for Ø 4 ... Ø 7 mm multipolar cables	8

Field wireable M12 male connectors

All measures in the drawings are in mm

General data



Technopolymer connector body
 Gold-plated contacts
 Screw terminals for cable screw fittings
 Max. operating voltages: 250 Vac/dc (5 poles)
 30 Vac/dc (8 poles)
 Maximum current: 4 A (5 poles)
 2 A (8 poles)
 Protection degree: IP67 acc. to EN 60529
 Ambient temperature: -25°C ... +85°C
 Wire cross-section: from 0.25 mm² (23 AWG) to 0.5 mm² (20 AWG)

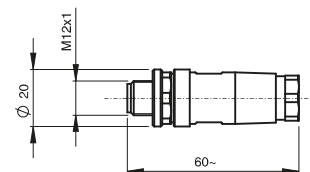

Article	Description	no. of poles
VF CCMP5DM04	Field wireable M12 male connector, straight, for Ø 4 ... Ø 6.5 mm multipolar cables	5
VF CCMP8DM04	Field wireable M12 male connector, straight, for Ø 4 ... Ø 7 mm multipolar cables	8

ATTENTION: always disconnect the power supply before removing the connector. The connector is not suitable for separation of electrical loads.

Items with code on green background are stock items

→ The 2D and 3D files are available at www.pizzato.com

Strain relief cable glands

Packs of 10 pcs.



This particular design ensures high resistance to traction of the cable glands. All cable glands are also suitable for a wide range of cable diameters.

Suitable for circular cross-section cables only.

Technical data:

Body and ring material: technopolymer without halogen
 Protection degree: IP67 acc. to EN 60529
 Tightening torque: 3 ... 4 Nm (PG 13.5/M20)
 2 ... 2.5 Nm (PG 11/M16)

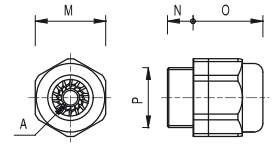

	Article	Description	A	⊙M	N	O	P
Metric threads	VF PAM25C7N	Cable gland M25x1.5 for a cable from Ø 10 to Ø 17 mm	⊙	30	10	28	M25x1.5
	VF PAM20C6N	M20x1.5 cable gland for one cable Ø 6 ... 12 mm	⊙	24	9	24	M20x1.5
	VF PAM20C5N	M20x1.5 cable gland for one cable from Ø 5 ... 10 mm	⊙	24	9	24	M20x1.5
	VF PAM20C3N	M20x1.5 cable gland for one cable Ø 3 ... 7 mm	⊙	24	9	24	M20x1.5
	VF PAM16C5N	M16x1.5 cable gland for one cable Ø 5 ... 10 mm	⊙	22	7.5	23	M16x1.5
	VF PAM16C4N	M16x1.5 cable gland for one cable Ø 4 ... 8 mm	⊙	22	7.5	23	M16x1.5
	VF PAM16C3N	M16x1.5 cable gland for one cable Ø 3 ... 7 mm	⊙	22	7.5	23	M16x1.5
	VF PAM20CBN	M20x1.5 multi-hole cable gland for 2 cables Ø 3 ... 5 mm	⊙	24	9	23	M20x1.5
	VF PAM20CDN	M20x1.5 multi-hole cable gland for 3 cables Ø 1 ... 4 mm	⊙	24	9	23	M20x1.5
	VF PAM20CEN	M20x1.5 multi-hole cable gland for 3 cables Ø 3 ... 5 mm	⊙	24	9	23	M20x1.5
	VF PAM20CFN	M20x1.5 multi-hole cable gland for 4 cables Ø 1 ... 4 mm	⊙	22	9	23	M20x1.5
	PG threads	VF PAP13C6N	PG 13.5 cable gland for one cable from Ø 6 ... 12 mm	⊙	24	9	24
VF PAP13C5N		PG 13.5 cable gland for one cable from Ø 5 ... 10 mm	⊙	24	9	24	PG 13.5
VF PAP13C3N		PG 13.5 cable gland for one cable from Ø 3 ... 7 mm	⊙	24	9	24	PG 13.5
VF PAP11C5N		PG 11 cable gland for one cable from Ø 5 ... 10 mm	⊙	22	7.5	23	PG 11
VF PAP11C4N		PG 11 cable gland for one cable from Ø 4 ... 8 mm	⊙	22	7.5	23	PG 11
VF PAP11C3N		PG 11 cable gland for one cable from Ø 3 ... 7 mm	⊙	22	7.5	23	PG 11

Threaded nuts

Packs of 10 pcs.

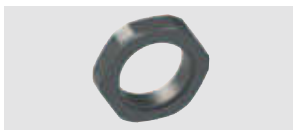
**Technical data:**

Body material: technopolymer
 Tightening torque: 1.2 ... 2 Nm

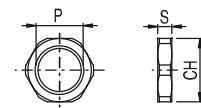

	Article	Description	S	CH	P
Plastic	VF DFPM25	Plastic nut, threaded, M25x1.5	6	32	M25x1.5
	VF DFPM20	Plastic nut, threaded, M20x1.5	6	27	M20x1.5
	VF DFPM16	Plastic nut, threaded, M16x1.5	5	22	M16x1.5
	VF DFPP13	Plastic nut, threaded, PG13.5	6	27	PG 13.5
Metal	VF DFMM20	M20x1.5 threaded nut in nickel-plated brass	3	23	M20x1.5

Items with code on green background are stock items

→ The 2D and 3D files are available at www.pizzato.com

LED signalling lights

Packs of 5 pcs.



These signalling lights with high luminosity LEDs are used for signalling that an electric contact has changed its state inside the switch. They can be installed only on switches of the FL, FX, FZ, FW, FG, NG or FS series by screwing them on one of the conduit entries not used for electric cables. They can be used for many different purposes: for example, in combination with a rope switch (e.g. FL 1878-M2) they can be used to signal (also at a certain distance) if the switch has been actuated.

In combination with safety switches with separate actuator (e.g. FL 693-M2), they can instead be used to signal if the protection is closed correctly or not. In combination with solenoid safety switches (FS, FG or NG series), they can signal if the protection is locked or unlocked. If they are combined with any switch of the FL, FX, FW or FZ series they can be used to calibrate the actuator. Their inner part can rotate in such a way that it can be wired and screwed on the switch without any risk of kinking the wires.

Technical data:

Protection degree:	IP67 acc. to EN 60529 and IP69K acc. to ISO 20653
Ambient temperature:	-25°C ... +70°C
Operating voltage Un:	24 Vac/dc 120 Vac 230 Vac
Tolerance on the supply voltages:	±15% of Un
Operating current:	10 mA
Connection system:	PUSH-IN spring type
Cross-section of rigid/flexible wires w. wire-end sleeve:	min. 1 x 0.34 mm ² (1 x AWG 24) max 1 x 1.5 mm ² (1 x AWG 16)
Wire cross-section with pre-insulated wire-end sleeve:	min. 1 x 0.34 mm ² (1 x AWG 24) max 1 x 0.75 mm ² (1 x AWG 18)
Cable stripping length (x):	min.: 8 mm max.: 12 mm
Tightening torque.	1.2 ... 2 Nm

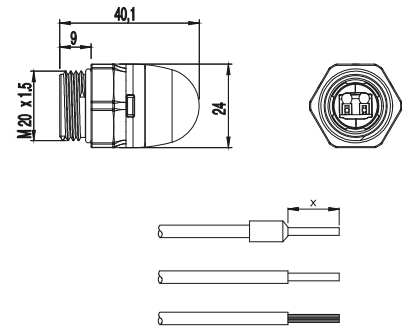
**Code structure**

Attention! The feasibility of a code number does not mean the effective availability of a product. Please contact our sales office.

VF SL1A3PA1

Operating voltage		<table> <tr> <td>2</td> <td>White</td> </tr> <tr> <td>3</td> <td>Red</td> </tr> <tr> <td>4</td> <td>Green</td> </tr> <tr> <td>5</td> <td>Yellow</td> </tr> </table>	2	White	3	Red	4	Green	5	Yellow
2	White									
3	Red									
4	Green									
5	Yellow									
1	24 Vac/dc									
3	120 Vac									
4	230 Vac									
Type of light source		<table> <tr> <td>P</td> <td>PUSH-IN terminal strip</td> </tr> </table>	P	PUSH-IN terminal strip						
P	PUSH-IN terminal strip									
A	standard LED with continuous light									
Body design		<table> <tr> <td>A</td> <td>Total height 40 mm, spherical lens, threading M20x1.5mm</td> </tr> </table>	A	Total height 40 mm, spherical lens, threading M20x1.5mm						
A	Total height 40 mm, spherical lens, threading M20x1.5mm									
A	Total height 40 mm, spherical lens, threading M20x1.5mm									

Stock items

VF SL1A3PA1
VF SL1A5PA1

Items with code on **green** background are stock items

→ The 2D and 3D files are available at www.pizzato.com